

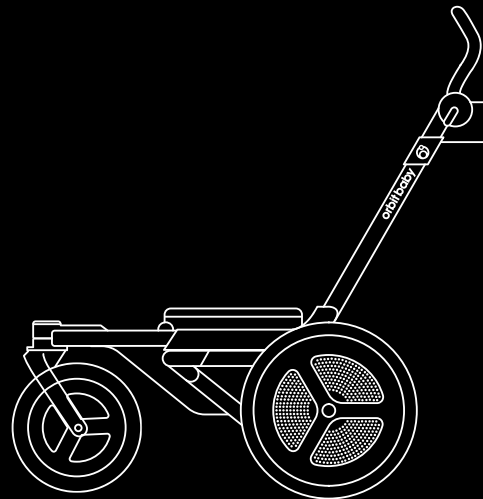

X5 Stroller Base

Complies with ASTM F833-21 /16 CFR 1227

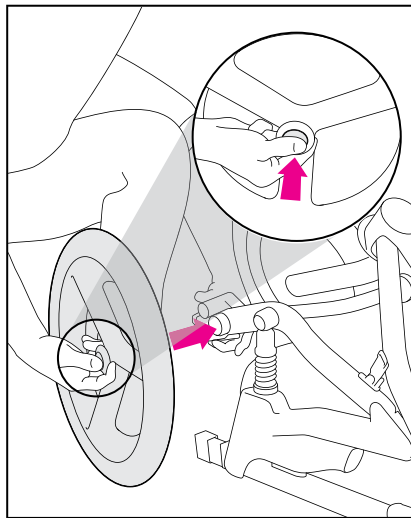

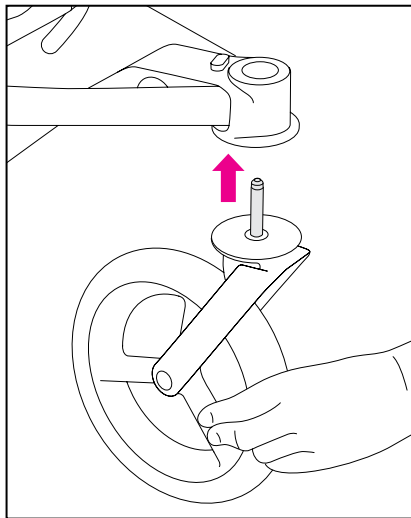
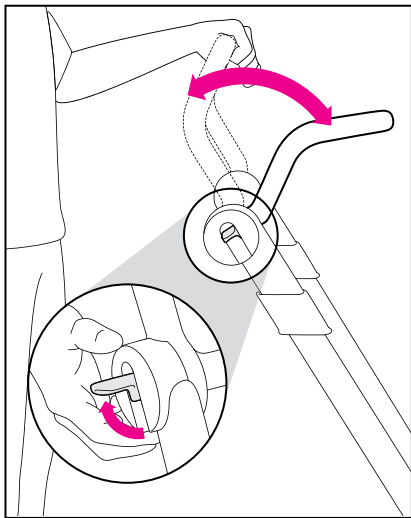

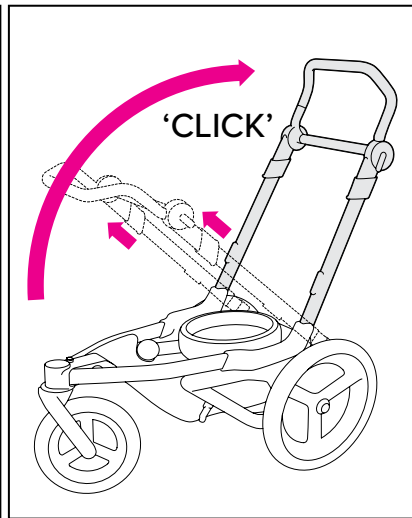
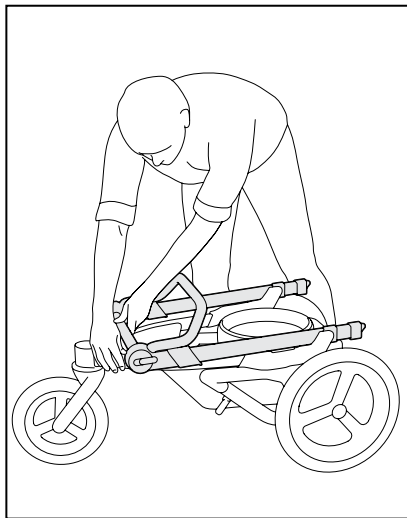
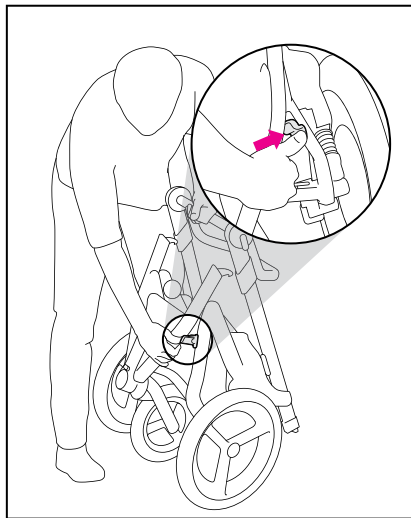

02 

03

04

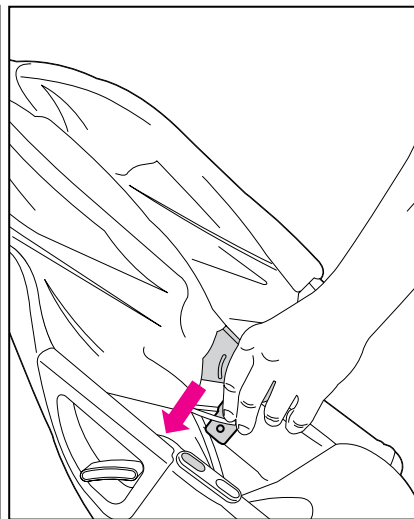
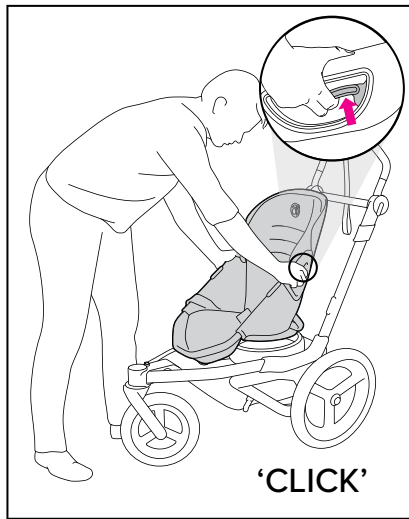
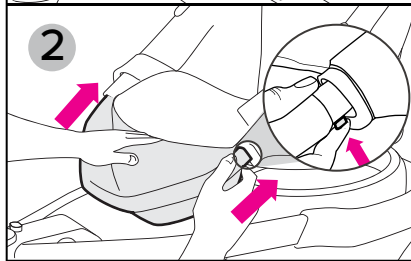
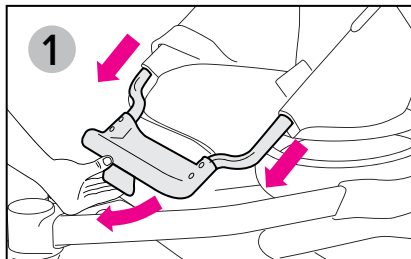

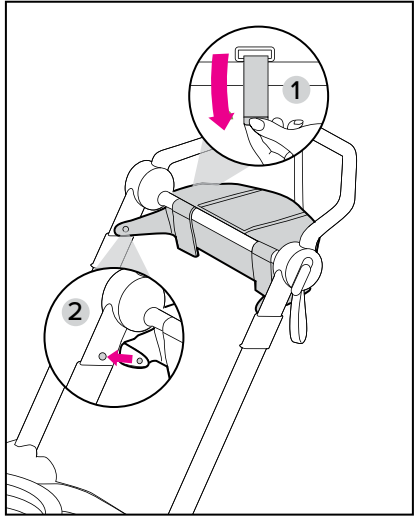
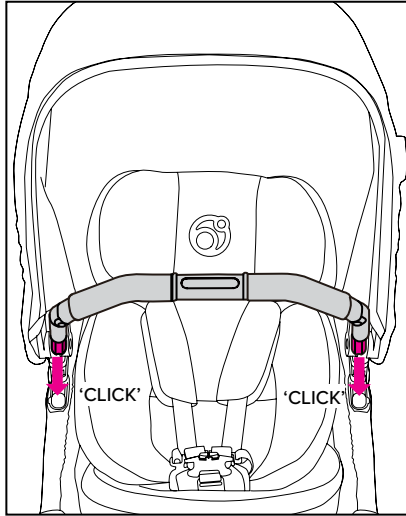
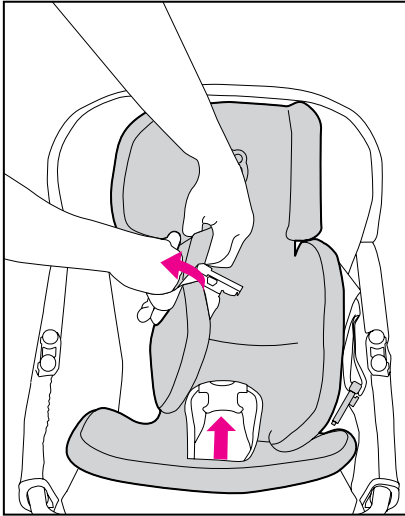

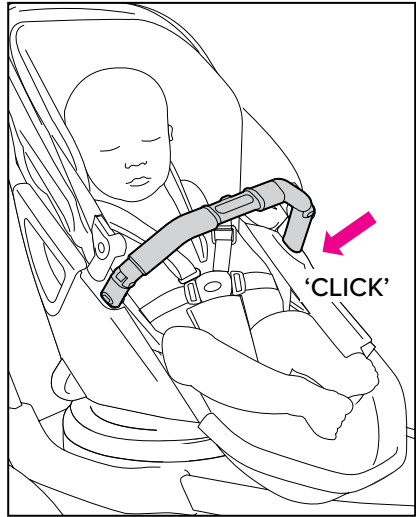
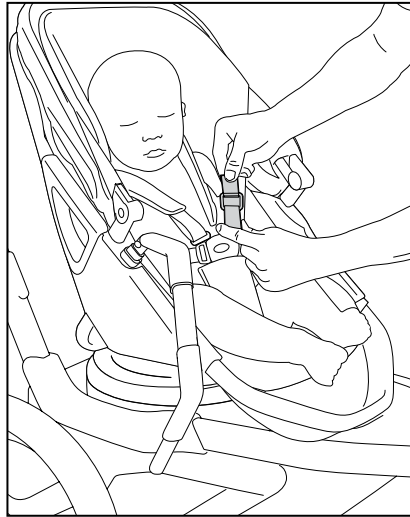
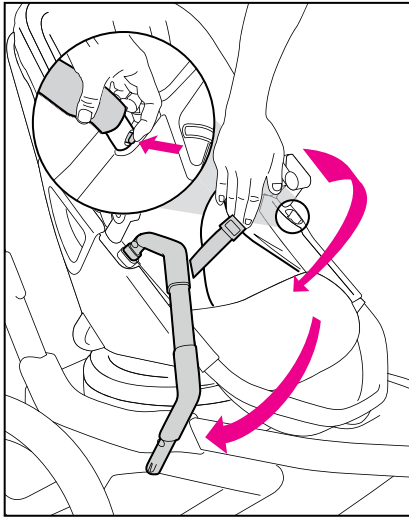

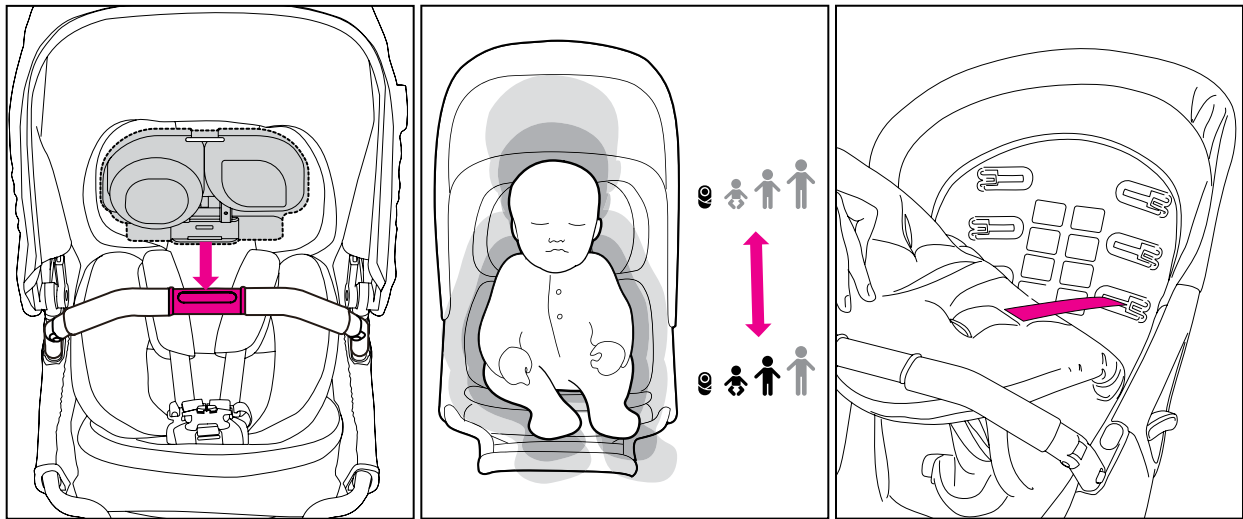

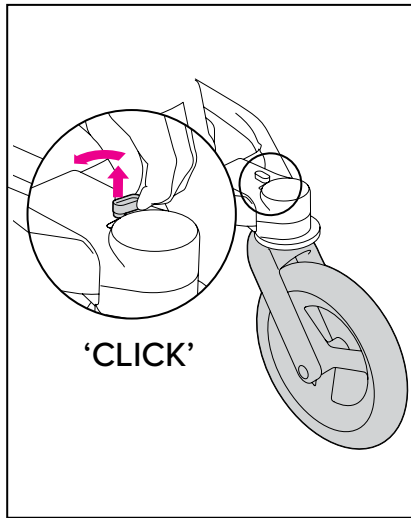
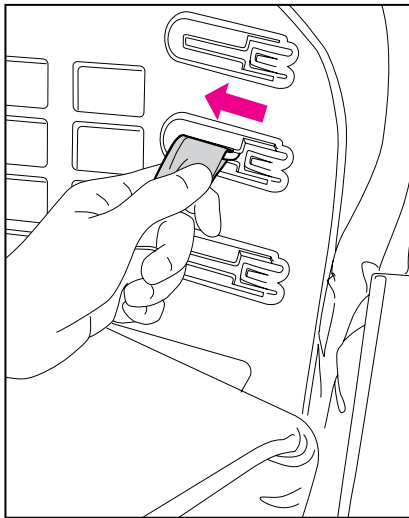
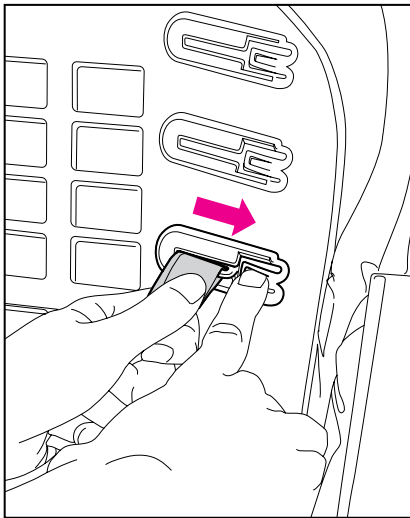

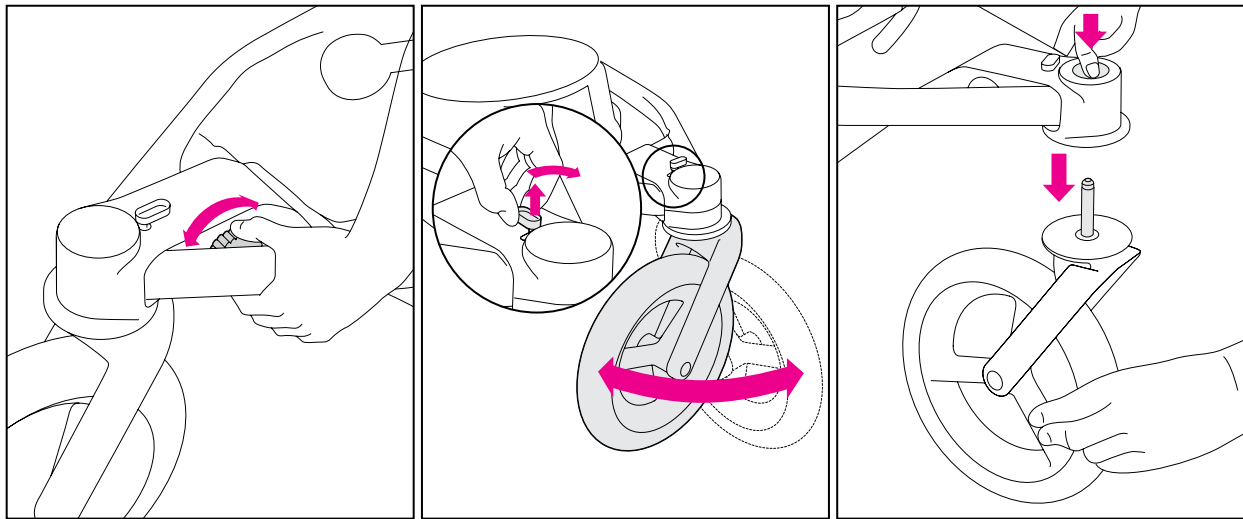

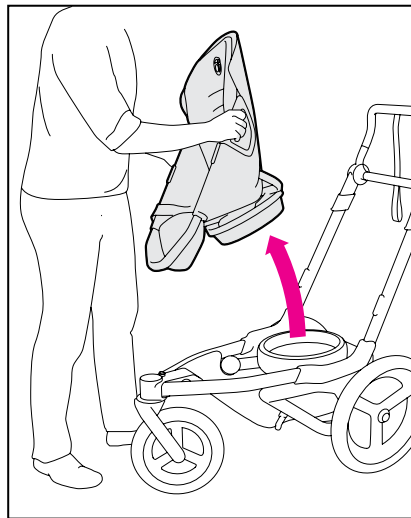
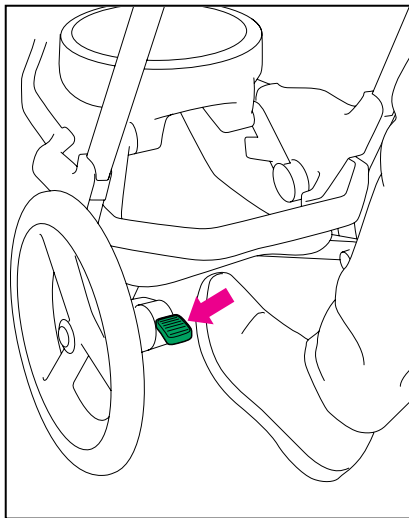
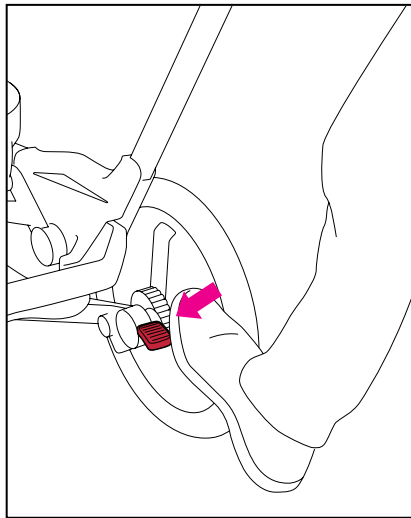

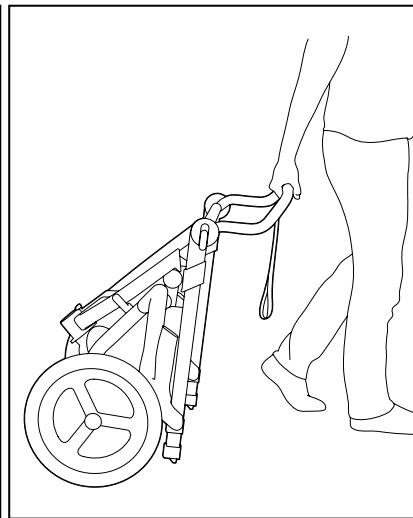
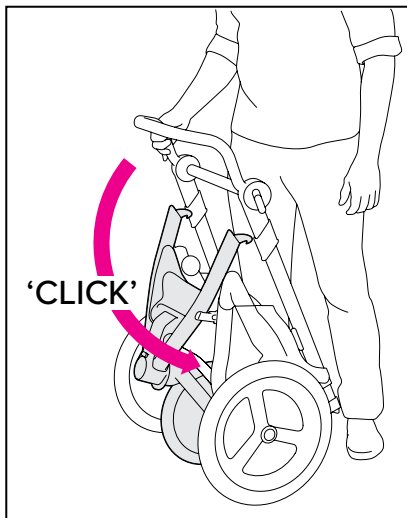
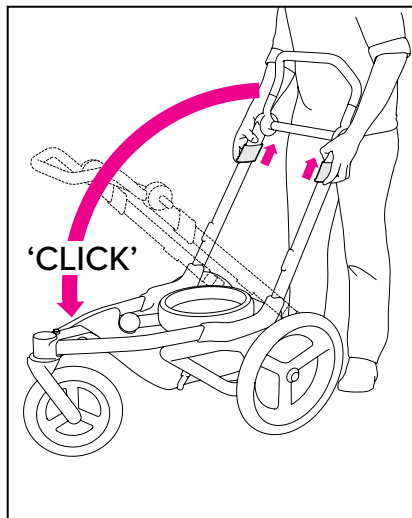

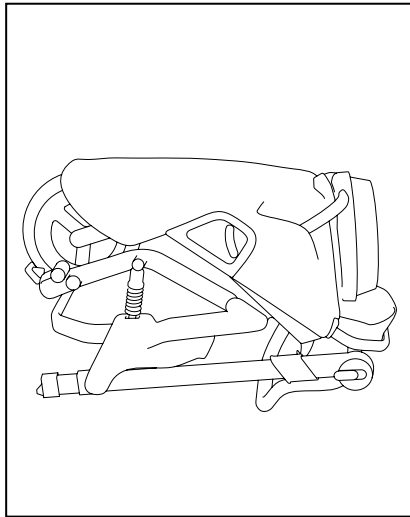
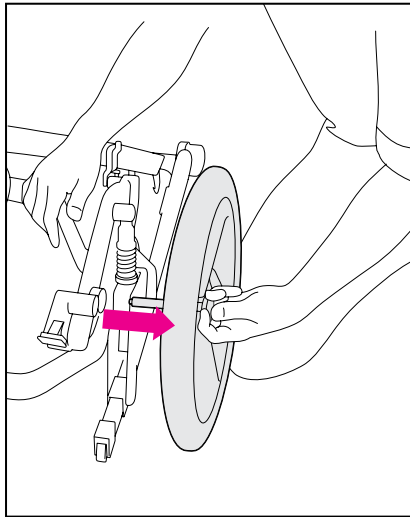
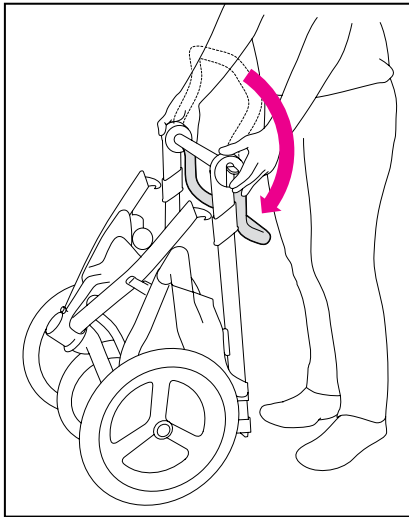

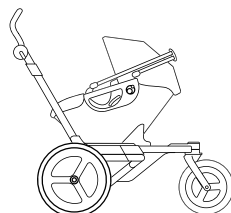
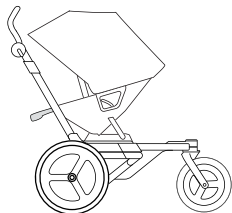
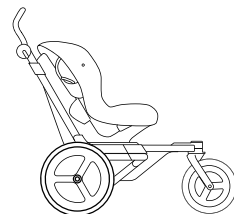
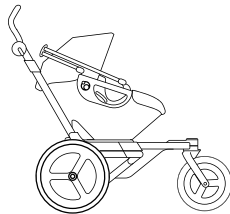
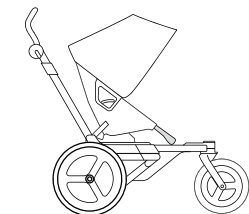
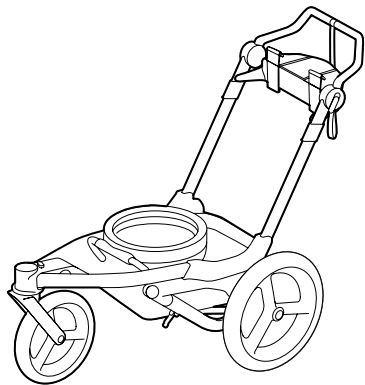





INDEX

	Getting Started	19
	Securing Your Infant	21
	Using Your Stroller	22
	Traveling & Storing	22



Cleaning

23



Warnings

24

Important : Read these instructions carefully before use and keep them for future reference. Your child's safety may be affected if you do not follow these instructions.

This manual describes how to use the products shown below.

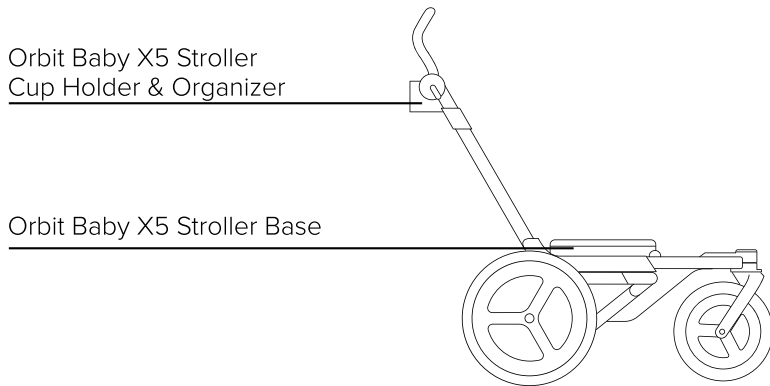

Using this Instruction Manual :

Each step is described in text and illustrations and referenced in the beginning of the instruction manual. Numbers referenced **01** in the text instructions refer to the related sections in the illustrations. Boxes referenced **□** in the text instructions refer to individual illustrations of the related sections. Letters like **Ⓐ** refer to the product parts identified on the labeled illustrations.

Product illustrations may not reflect the actual appearance of the enclosed product. All product specifications subject to change.

X5 Stroller Base

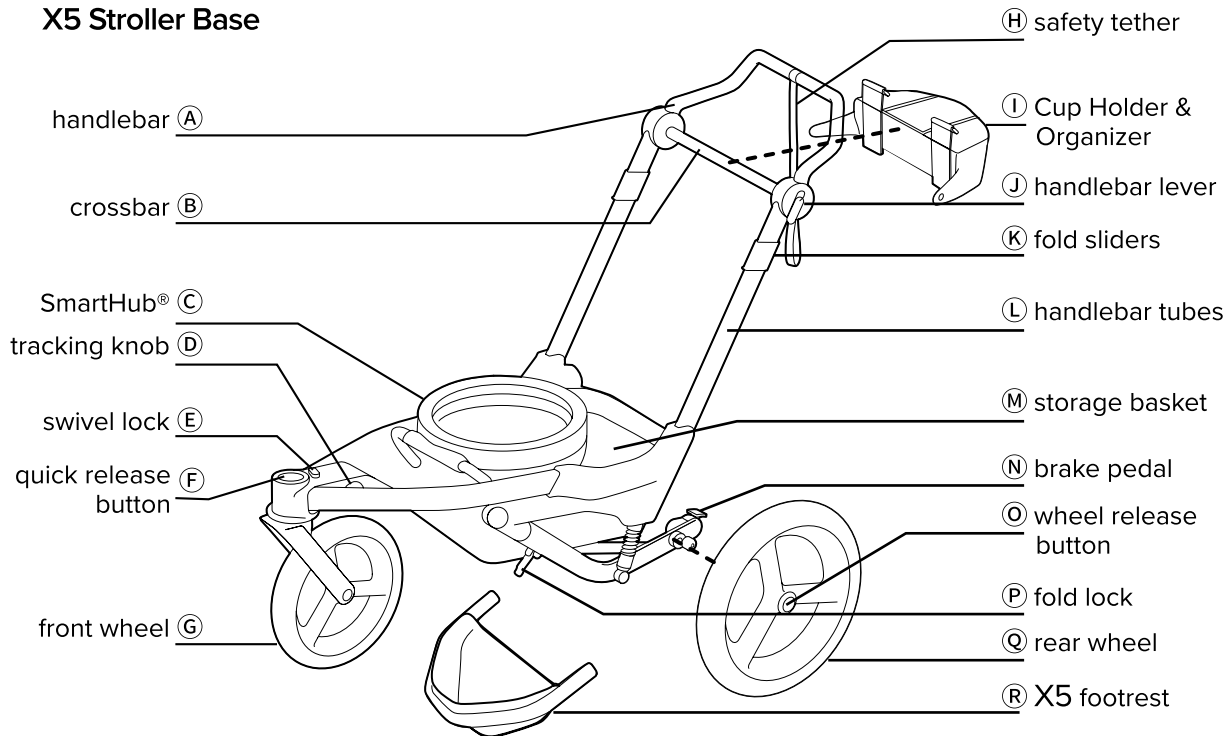

The product information label is located underneath the stroller base.

G5 Stroller Seat (sold separately)

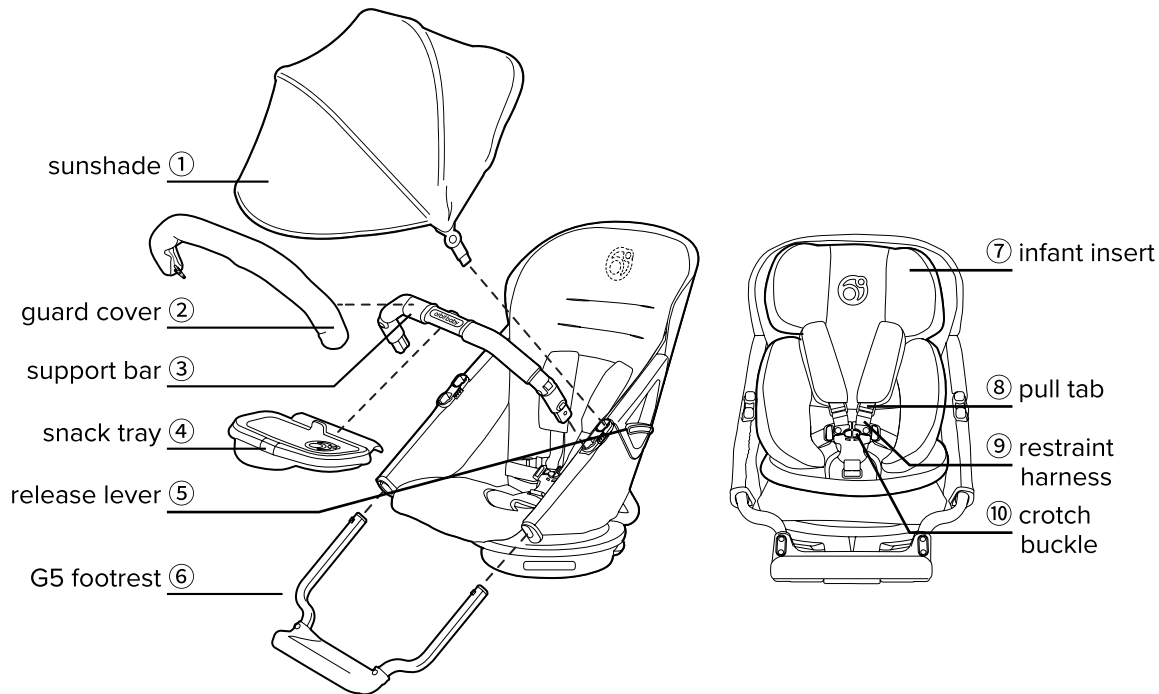

GETTING STARTED

Remove all the parts from the box. For Stroller Base you should have received a stroller base, one (1) X5 footrest , one (1) front wheels, two (2) rear wheels, and (1) Cup Holder & Organizer. These parts are illustrated in your manual.

WARNING

AGE RECOMMENDATION - JOGGING USAGE

- As each child's development is different, you should always consult with your pediatrician before using the Orbit Stroller for jogging with your baby.
- Subject to your pediatrician's advice, for jogging use, it is generally recommended that your child should be at least 8 months old.
- In addition, only use an Orbit Baby seat that is rated for your child's age, weight and height, and specially approved for usage in the X5 Stroller.

01 Unfolding the stroller base

- Your stroller base comes folded in the box.
- Adjust the handlebar before unfolding the frame for the first time. To adjust handlebar (A) to your desired position, fully open both handlebar levers (J) with your fingers, rotate the handlebar, and then relock the handlebar levers closed.
- Insert the front wheels (G) into the front cross brace. You will hear a **CLICK** when they are locked in place.
- Press the wheel release button (C) and insert the rear wheel (Q) into the rear leg. Once axle is fully inserted, release wheel release button, and pull out on wheel to assure that is locked in place.
- Repeat with other side. Holding the crossbar (B) in your left hand, push out on the fold lock (P) with your right thumb.
- Rotate the front of the stroller forward with your right hand until all three wheels are touching the ground.
- Push up on both fold sliders (K) and raise the handlebar tubes (L) until they are locked in place. You should hear a **CLICK**.

02 Using the X5 footrest

- Replace the original footrest on your stroller seat with the X5 footrest [®] whenever using your stroller seat on the X5 Jogger frame.

03 Attaching an Orbit Baby seat

- Dock the seat into the SmartHub[®] [©] and rotate it to one of the locking positions. You will hear a **CLICK** when it locks into one of the use positions.

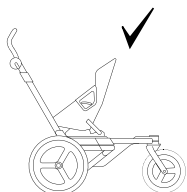

Fully Upright



Mid-Recline

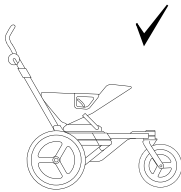

Full-Recline

04 Assembling the stroller seat (required for initial assembly, storage and travel only)

- Assemble the sunshade ^① by inserting both sunshade mounts into the upper set of holes on the stroller seat. You will hear a **CLICK**.
- If your child weighs less than 15 lbs (7 kg), place the Orbit Baby Infant Insert ^⑦ in the stroller seat before loading your child.
- Orient the support bar ^③ so the Orbit Baby text is in the correct direction. Insert the support bar into the lower set of holes on the stroller seat. You will hear a **CLICK**.

05 Attaching the Cup Holder & Organizer

- The cup holder & organizer ^① attaches to the crossbar ^② with the Velcro strap.
- Fasten the cup holder & organizer to handlebar tubes ^④ with snaps as shown.

SECURING YOUR INFANT

06 Securing your child

- Open one side of the support bar ③ by pushing on the oval button. Hook the buckle tongues of the restraint harness ⑨ in the upholstery flaps to keep them out of the way while loading the child.
- Place your child in the stroller seat. Place the restraint harness around your child and insert the buckle tongues into the crotch buckle ⑩. You should hear two **CLICKS**. Adjust the harness to tightly fit around your child by pulling up and down on the webbing pull tab ⑧. To release the buckle, press the red buttons while simultaneously squeezing the side tabs. See section 07 for adjusting the height of the shoulder straps.
- Close the support bar. You should hear a **CLICK**.
- Clip the snack tray ④ over the center portion of the support bar.
- Open the lid of the snack tray by squeezing tab and pulling back.

07 Adjusting the shoulder strap height

- The height of the shoulder straps can be adjusted based on the size of your child. They should be positioned in the slot at or slightly above your child's shoulders.
- Remove the memory foam padding from the seat (if applicable). Once removed, peel back the top right and left corners of the seat padding, attached by Velcro. This will give you access to the adjusting shoulder stoppers and slots.
- Press release tab on the seat shell and slide plastic harness stopper from the slot and pull the harness through the upholstery seat padding.
- Re-thread each shoulder strap through the correct upholstery slot and insert stopper into the corresponding shell slot at the new height. You should hear a **CLICK**. Ensure the harness is secure by tugging on the shoulder strap. Reattach upholstery to stroller seat Velcro and replace Memory foam padding (if applicable).

USING YOUR STROLLER

08 Front wheels swivel & removal

- To stop the front wheel from swiveling, pull up and rotate the front wheel swivel lock (E) counterclockwise, into the locked position and rotate the front wheel to straighten it until you hear a **CLICK**.
- To adjust locked front wheel position, twist the tracking knob (D) in the appropriate direction.
- To unlock, PULL UP and rotate the front wheel swivel lock clockwise, into the unlocked position.
- While pressing quick release button (F), gently slide the front Wheel (G) out of the front wheel mount.

09 Using the stroller brakes

- Lock the brakes by pressing firmly down on the red brake pedal (N) with your foot. Confirm that the brake is engaged by gently rocking the stroller.
- Unlock the brakes by pressing firmly down on the green pedal.

TRAVELING & STORING

10 Folding the stroller

- Remove the child from the Orbit Baby seat. Undock the seat from the SmartHub® and set aside where children cannot access it.
- Pull both fold sliders up and rotate the handlebar tubes forward. You will hear a **CLICK**.
- Grab handlebar and pull back to fold the stroller base. The fold lock will engage when the stroller base is fully folded. You will hear a **CLICK**.

11 Storing and moving the folded stroller

- To pull the folded stroller base in wheelie mode, rotate the front wheel so it is not touching the ground and adjust the handlebar position so the bottom of the handlebars are not touching the ground as you are pulling along the handlebar.

12 Packing the stroller seat for travel or storage

- Fully open both handlebar levers, rotate the handlebar down so it touches the frame. Lock both handlebars levers.
- Remove both rear wheels by pushing the wheel release button and pulling out on the wheel.
- For compact storage of the stroller seat with the stroller base, place the folded stroller base with the SmartHub® facing down and nest the stroller seat onto it with the stroller seat hub located next to the stroller handlebar as shown.

CLEANING

Cleaning Instructions :

Avoid excessive exposure to sun or heat, which may cause fading or warping. Keep the SmartHub®, handlebar and folding mechanisms, and front wheel swivel lock free of abrasive grime and moisture. If wet, use a soft cloth to dry. Regularly check all rivets, screws and safety devices for tightness and security. Inspect wheels and tether strap and replace if necessary. All hard goods (plastic and metal) may be wiped clean with a damp cloth. Never use bleach or detergents. Do not submerge or use running water on any metal or plastic parts of the stroller. The storage basket (M) and X5 Stroller Cup Holder & Organizer (I) can be cleaned with a clean wet cloth.

Maintenance Instructions :

For the front wheel & the rear wheels, remove them using the wheel quick release button, change the tire and then reinstall. Pull outward on the wheels to ensure they are securely attached to the stroller.

WARNING

FAILURE TO FOLLOW THESE WARNINGS AND THE INSTRUCTIONS COULD RESULT IN SERIOUS INJURY OR DEATH. PREVENT SERIOUS INJURY OR DEATH:

- NEVER leave your child unattended.
- Always provide the supervision necessary for the continued safety of your child.
- Stroller must be fully opened and locked in position prior to use. Listen for the audible CLICK to confirm that it is fully deployed.
- Use caution when pushing stroller near traffic or in highly congested areas.
- This product is not suitable for skating.
- To avoid injury ensure that your child is kept away when unfolding and folding this product.
- Do not let your child play with this product.
- Do not let others use the Orbit Baby X5 Stroller Base or other connected Orbit Baby products unless they understand how to properly use them.
- Do not use the stroller if any part is damaged, broken, torn or missing. Use only replacement parts supplied and approved by the manufacturer. If the instruction manual is missing or you need replacement parts or assistance, see the contact information included in this product.
- This vehicle is intended for children up to a maximum weight of 50 lbs (23 kg). Maximum child weight in any seat on the X5 Stroller Base is 50 lbs (23 kg). Maximum child weight in the G5 Stroller Seat on the X5 Stroller Base is 50 lbs (23 kg).
- Do not allow children to touch or climb on the folded stroller.
- Avoid serious injury from falling or sliding out. Always use seat restraint system.
- Do not use the stroller for a child without the seat attached.
- Never allow a child to sit or stand on the Smart Hub®.

WARNING

FALL HAZARD FROM TIP OVER:

- Before running, jogging, or walking quickly, **LOCK** the front wheel from swiveling.
- Wheel can detach and cause tip over. Pull on the wheel to assure it is securely attached.
- Do not use stroller base without a seat attached.
- **DO NOT** use stroller on stairs or escalators with child in it.
- Do not place parcels or accessory items on the stroller unless made by or specially approved by Orbit Baby. Added parcels or accessory items can make the stroller become unstable.
- Any load attached to the handle affects the stability of stroller or pram/pushchair.
- Do not place more than 1lbs (0.5 kg) in the cup holder & organizer. Excessive weight may cause a hazardous unstable condition to exist.

- **ALWAYS** be careful on uneven terrain, and watch your speed.

AVOID BURN INJURY :

- Never use the Orbit Baby X5 Stroller Cup Holder & Organizer to hold hot liquids. These liquids may splash and spill onto you or your child and cause injury.

AVOID LOSS OF CONTROL OF THE STROLLER :

- **ALWAYS** use front wheel swivel lock when pushing stroller on uneven terrain.
- Use caution when pushing stroller on uneven terrain or hills.
- **ALWAYS** lock the parking brake when the stroller is stopped.
- **NEVER** leave stroller unattended on a hill or incline even when parking brake is locked.
- Do not place more than 5 lbs (2 kg) in the storage basket. Excessive weight may cause a hazardous unstable condition to exist.
- Use the stroller safety tether whenever Avoid jogging or walking fast with the stroller.

WARNING

PINCH HAZARD :

- Avoid injury from pinching or finger entrapment. Keep children away when unfolding and folding the stroller. Use caution and Keep hands and fingers, especially of children, clear of moving parts as you fold and unfolding the stroller.
- Stroller must be fully erected and locked in position prior to use. Listen for the audible **CLICK** to conrm that it is fully deployed.
- Ensure that all the locking devices are engaged before use.

PREVENT SERIOUS INJURY OR DEATH :

- Wheel can detach if not securely attached. Pull on the wheel to assure it is securely attached.

STRANGULATION HAZARD :

- The safety tether is intended to be used by an adult to maintain control of stroller while jogging.

- Do not hang items from the safety tether.
- To use tether strap, insert hand through loop and always hold onto stroller handle while jogging and strolling.
- Keep stroller tether out of child's reach.
- Children can choke on foam. Only use with cover installed.
- Do not place in or near this stroller any cord, strap or similar item that could become wrapped around a child's neck.
- Do not place this stroller near a window or a patio door where a child could reach the cord of a blind or curtain and be strangled.

FALL HAZARD FROM TIP OVER :

- Keep the SmartHub® area clean. Keep all metal and plastic parts clear of objects, debris and liquids to allow proper and safe functionality.
- Listen for audible **CLICK** which indicates that the Orbit Baby seat is locked into the SmartHub®.
- Do not press parking brake while pushing the stroller.

WARNING

- Seats must be locked into the SmartHub® and securely into position before loading your child.
- Always check that the seat is securely locked into the SmartHub® by tugging seat upwards and turning.
- Lock the parking brakes and check stability when the stroller is stationary.
- Lock the stroller wheels and check stability of the Orbit Baby seat before placing your child in or removing your child from the Orbit Baby seat must always be locked in position before moving. Do not rotate the seat when the stroller is in motion.
- Check that the pram body or seat unit or car seat unit attachment devices are correctly engaged before use.
- The stroller base when used in conjunction with a car seat is not intended for prolonged periods of sleeping and does not replace a cot or a bed. Should your child need to sleep, a suitable pram body, cot, or bed should be used.

- Keep your hands on the handlebars whenever the parking brake is not engaged.

TO PREVENT FALLS :

- Always grasp both seat side handles when rotating or undocking any Orbit Baby seat.

PINCH HAZARD :

- When docking an Orbit Baby seat or adjusting your stroller, keep hands and fingers, especially of children, clear of moving parts and the SMART HUB.
- When adjusting and docking an Orbit Baby seat, always ensure all children's body parts are clear of moving parts when adjusting the seat. Keep your hands clear of moving parts when adjusting the stroller seat.

FALL HAZARD: Avoid serious injury from falls or sliding out

- Always use the Orbit Baby Infant Insert for infants under 15 lbs (7 kg). Use the infant insert only when the shoulder straps are in the lowest position. Infant insert must be used to ensure that the restraint harness properly restrains your child.



www.orbitbabyus.com

ORBIT BABY® and related logo, PAPARAZZI SHIELD® and SMARTHUB® are registered trademarks of Orbit Baby, Inc. in the United States and certain other jurisdictions.

ORB820006US | Rev 1.0 ©2021 Orbit Baby, Inc.
All rights reserved.

